



# Primer

## DDO-18 T2 TURBO OPTIMA stack dryers

### T2 CONTROL

User friendly and totally programmable 7" T2.  
USB Connection. Online platform free of charge for programming, telemetry, data analysis...thanks to the IoT.  
Videos on display (ads, instructions, etc.).  
37 languages.

### OUTSTANDING FEATURES

Reversing drum action as standard.  
Stainless steel drum as standard.  
Frequency inverter as standard.

### EFFICIENCY

DUAL AIRFLOW: mixed axial-radial airflow.  
Big fluff filter.

### CONNECTIVITY

IoT - PrimerLink.  
Management of laundries: OPL and COIN.  
Remote payment.

### VERSATILITY

Make to order: customisation.  
Wet Cleaning.  
OPL > Multivending - Standard OPL model easily transformable to coin laundry uses.

### ERGONOMICS

**IoT - PRIMERLINK standar.**  
Management of laundries: OPL and COIN.  
Remote payment (coin-laundry).

### EASY MAINTENANCE

Hinged control panel: easy and ergonomic access.  
Technical menu: statistics for technicians.

### OTHERS

Grey skinplate outer casing, stainless steel look  
EFFICIENT DRUM: new drum with stamped holes  
COOL DOWN: anti-wrinkle at the end of the cycle.  
Heating options: electric and gas, except model DDO-22 T2 gas only.  
CE approved.



### OPTIONS

- License IoT - PrimerLink
- SMART DRY for STACK (order 1 unit per column)
- Double doorglass (order 1 unit per column)
- NG gas option (Natural) for DDO
- Fire extinguisher STACK (order 1 unit per column)
- Tropicalized model (order 1 unit per column)
- Opposite door opening (order 1 unit per column)
- Dosing-spraying (order 1 unit per column)
- 400V III 50Hz 11/14/18kg
- Back panel with air filter (STACK)
- 400V III 60Hz 11/14/18/22kg
- Fluff filter with grid 0,3 mm (standard in STACK is 0,6 mm)
- 230V III 60Hz 11/14/18kg G
- 230V III 60Hz 11/14/18kg E
- 440V/480V III 60Hz 11/14/18/22kg (maritime)
- Stainless steel front and side panels DDO-18
- Front panel in stainless steel DDO-11/14/18
- Maritime wooden packing DDO-18
- Several payment systems for self-service

CAPACITY & DRUM	UNIT.	DDO-18 T2 TURBO	
Capacity 1/18	Kg	18,3	
	lb	40,4	
Capacity 1/20	Kg	16,5	
	lb	36,3	
Ø Drum	mm	750	
	inch	29,53	
Drum length	mm	746	
	inch	29,37	
Drum volume	l	330	
	cu ft	11,64	
Ø Door hole	mm	574	
	inch	22,60	
Door center height	mm	547 / 1522	
	inch	21,54 / 59,92	
Height from floor to bottom of door	mm	260 / 1.235	
	inch	10,24 / 48,62	
ELECTRIC HEATING			
Evaporation capacity	L/h	-	
	US gallon/h	-	
Hourly output	Kg/h	-	
	lb/h	-	
Installed heating power	kW	-	
Installed electrical power	kW	-	
Drum motor power	kW	0,37 x2	
GAS HEATING			
Evaporation capacity (gas model)	L/h	35,3	
	US gallon/h	9,325	
Hourly output (gas model)	Kg/h	70,7	
	lb/h	155,9	
Installed gas heating power	kcal/h	20650 x2	
	Btu/h	81891,4 x2	
Installed gas heating power	kW	24 x2	
Installed electrical power	kW	1,94	
Instant propane gas consumption (G31)	Kg/h	2,06 x2	
	lb/h	4,54 x2	
Instant natural gas consumption (G20)	m <sup>3</sup> /h	2,54 x2	
	cfm	1,49 x2	
Ø Gas inlet	BSPP ISO 228-1	1/2"	
VENTILATION			
Fan motor power	kW	0,55 x2	
Nominal air flow rate	m <sup>3</sup> /h	750 x2	
	cfm	441,43 x2	
Ø Fume exhaust	mm	200 x2	
Ø Fume exhaust	inch	7,78 x2	
HEAT EMISSION			
Maximum total heat emission	kW	2,5	
	Btu/h	8353,4	
Max. front heat emission	kW	1,8	
	Btu/h	6145,5	
CONNECTIONS		E	G / S
Tension 230V - I + N + T	Nº x mm <sup>2</sup> / A	-	3 x 2,5 / 20A
Tension 230V - III + T	Nº x mm <sup>2</sup> / A	-	3 x 2,5 / 20A (1*)
Tension 400V - III + N + T	Nº x mm <sup>2</sup> / A	-	3 x 2,5 / 20A (2*)
NET DIMENSIONS / D. WITH PACKING			
Net / gross width	mm	785 / 865	
	inch	30,91 / 34,06	



Net / gross depth	mm	1.443 / 1.457
	inch	53,81 / 57,36
Net height / gross height without heating	mm	1.980 / 2.126
	inch	77,95 / 83,70
Net / gross weight	Kg	320 / 349
	lb	705,48 / 769,41
<b>OTHERS</b>		
Sound level	dB	64

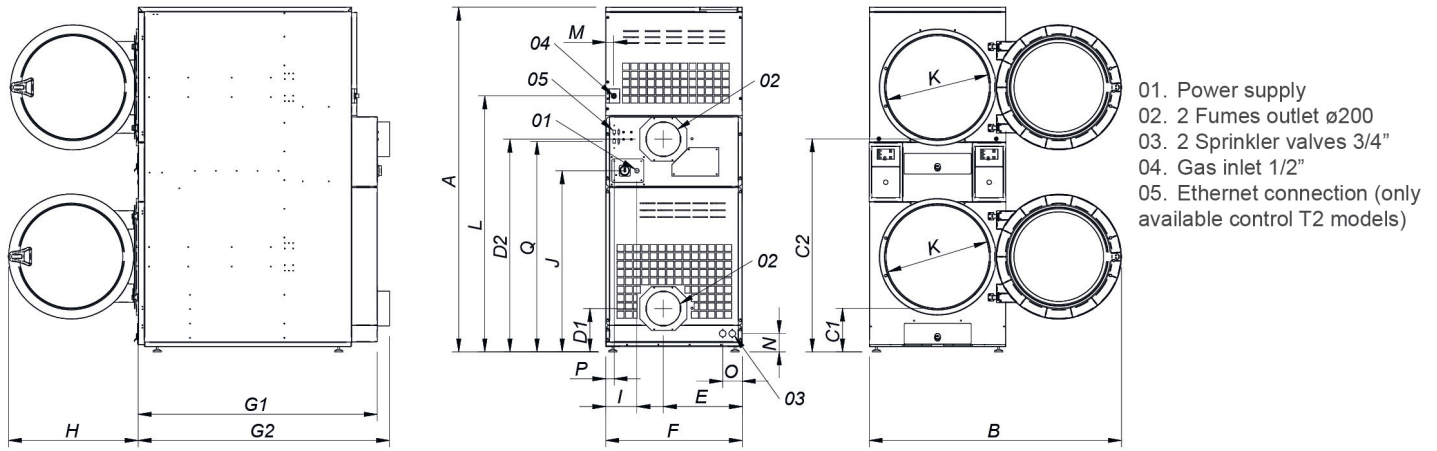

\* Measurement with legs mounted (30mm)

	A	B	C1	C2	D1	D2	E	F	G1	G2	H	I	J	K	L	M	N	O	P	Q
DDO-18 TURBO	1980*	1447	259	1234	250	1223	454	785	1374	1443	735	180	1040	575	1472	45	103	100	49	1210

