



# Primer

## DP-10 P MONO BASIC Professional dryers P - BASIC

### FEATURES

P PROGRAMMER: selection of time and temperature, user friendly and versatile (OPL or coin laundry version).  
Reduced drying times (less than 45 minutes).  
Electric heating only 4,5 kW.

### VERSATILITY

OPL <> COIN: Standard models can be programmed as OPL or coin laundry version, central pay, etc.  
SINGLE <> STACKED: Models can be stacked on top of a washer or on another dryer.  
Control panels can be assembled between both drums for better ergonomics.  
Ideal for multiple solutions: hotels, hostels, campings, coin laundries, facility services (mops), gyms, etc.  
New gas heated models.

### EFFICIENCY

Optimised airflow.  
Wide fluff filter as drawer.  
Efficient design.

### ROBUSTNESS

White lacquered model.  
Robust aluminium big door.  
Drawer as fluff filter (not in the door but as a specific drawer).  
Industrial fan and powerful airflow.  
Sturdy construction of the dryer structure and panels.

### OTHERS

Galvanized drum.  
Models with electric or gas heating.  
FULL SCREEN FILTER: drawer fluff filter, not in the door.  
Models with electric or gas heating.  
HPDL model available in two versions: three-phase model or single-phase model (non-convertible).



### OPTIONS

- Plinth for better ergonomics in skinplate
- Plinth for better ergonomics in stainless steel
- Drum stainless steel AISI 304
- Outer casing stainless steel AISI 430
- Reverse door opening
- Control panel mounted below (stacked dryer)
- Fire extinguisher (T2)
- Order in complete container + compact packing
- 400V III / 230 I / III 60 Hz
- 440-480V III 50/60 Hz no N (maritime)
- NG gas option (Natural)
- Several payment systems for self-service

CAPACITY & DRUM		UNIT.	DP-10 P MONO BASIC	
Capacity 1/18		Kg	11,1	
		lb	24,5	
Capacity 1/20		Kg	10	
		lb	22	
Ø Drum		mm	590	
		inch	23,23	
Drum length		mm	690	
		inch	27,17	
Drum volume		l	200	
		cu ft	7,06	
Ø Door hole		mm	480	
		inch	18,90	
Door center height		mm	554	
		inch	21,81	
Height from floor to bottom of door		mm	250	
		inch	9,84	
ELECTRIC HEATING				
Evaporation capacity		L/h	6,35	
		US gallon/h	1,68	
Hourly output		Kg/h	12,5	
		lb/h	27,6	
Installed heating power		kW	4,5 (1)	
Installed electrical power		kW	4,92 (1)	
Drum motor power		kW	0,37 (2)	
GAS HEATING				
Evaporation capacity (gas model)		L/h	6,35	
		US gallon/h	1,677	
Hourly output (gas model)		Kg/h	12,5	
		lb/h	27,6	
Installed gas heating power		kcal/h	5761	
		Btu/h	22861,3	
Installed gas heating power		kW	6,70	
Installed electrical power		kW	0,42	
Instant propane gas consumption (G31)		Kg/h	0,57	
		lb/h	1,26	
Instant natural gas consumption (G20)		m <sup>3</sup> /h	0,71	
		cfm	0,42	
Ø Gas inlet		BSPP ISO 228-1	1/2"	
THERMAL OIL HEATING				
Installed heating power		kW	-	
Installed electrical power		kW	-	
Fluid consumption (T max 175°C)		m <sup>3</sup> /h	-	
Thermal oil connection		BSP	-	
VENTILATION				
Fan motor power		kW	0,37(2)	
Nominal air flow rate		m <sup>3</sup> /h	300	
		cfm	176,57	
Ø Fume exhaust		mm	100	
Ø Fume exhaust		inch	3,94	
HEAT EMISSION				
Maximum total heat emission		kW	0,45	
		Btu/h	1536,4	
Max. front heat emission		kW	0,32	
		Btu/h	1075,5	
CONNECTIONS				
Tension 230V - I + N + T		Nº x mm <sup>2</sup> / A	E 3 x 10 / 40A	G 3 x 1,5 / 10A



Tension 230V - III + T	Nº x mm <sup>2</sup> / A	4 x 4 / 25A	3 x 1,5 / 10A (3)
Tension 400V - III + N + T	Nº x mm <sup>2</sup> / A	5 x 2,5 / 16A	3 x 1,5 / 10A (4)
<b>NET DIMENSIONS / D. WITH PACKING</b>			
Net / gross width	mm	680 / 710	
	inch	26,77 / 27,95	
Net / gross depth	mm	775 / 832	
	inch	30,51 / 32,76	
Net height / gross height without heating	mm	1.056 / 1.141	
	inch	41,57 / 44,92	
Net / gross weight	Kg	92,6 / 104,1	
	lb	204,15 / 229,50	
<b>OTHERS</b>			
Sound level	dB	62	

- (1)- Configurable through a terminal system
- (2)- It is a single motor for drum and fan
- (3\*) Connect 2 phases and ground
- (4\*) Connect phase, neutral and ground

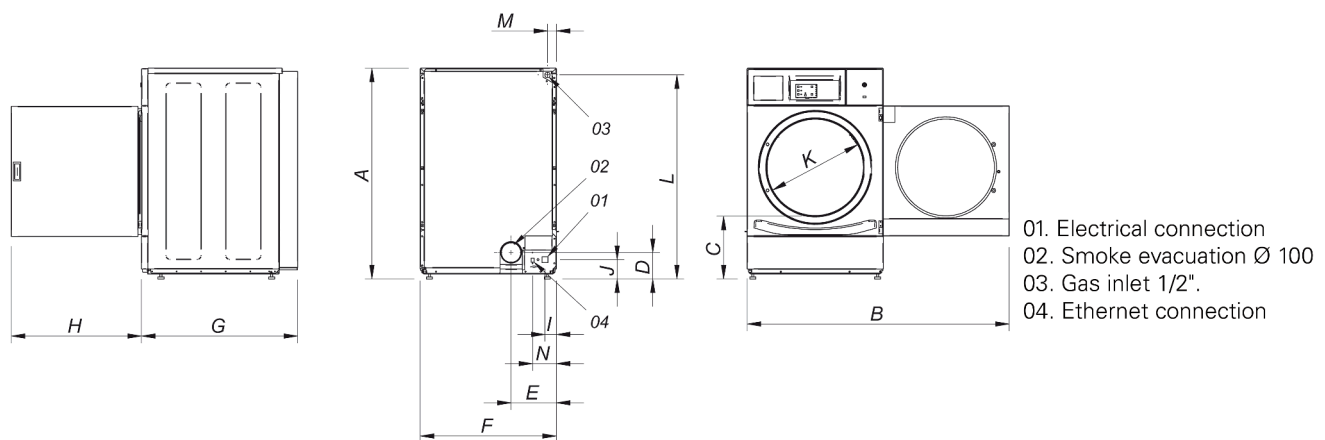

	A	B	C	D	E	F	G	H	I	J	K	L	M	N
DP-10 BASIC	1.056	1.227	320	140	226	680	775	615	57	91	480	1.015	50	118

