



Primer

DP-8 T2 HPI HPI Professional tumble dryers with HEAT PUMP

OUTSTANDING FEATURES

T2 microprocessor: easy to use and fully programmable with 4.3" touch screen.
Frequency control standard.
Reverse drum action standard.
USB port.
Remote connection.



OPTIONS

- 400V 3~ 50/60Hz HPI
- License IoT - PRIMERLINK
- PRIMER LAUNDRY App - Self service (iOS / Android)
- Reverse door opening
- Outer casing stainless steel AISI 430 for HPI
- Tropicalized model: protected board (T2)
- 440/480V 3~ 50/60Hz HPI
- Several payment systems for self-service

CAPACITY & DRUM		UNIT.	DP-8 T2 HPI
Capacity 1/18		Kg	8,9
		lb	19,6
Capacity 1/20		Kg	8
		lb	17,6
Ø Drum		mm	590
		inch	23,2
Drum length		mm	585
		inch	23
Drum volume		l	160
		cu ft	5,65
Ø Door hole		mm	480
		inch	18,9
Door center height		mm	918
		inch	36,1
Height from floor to bottom of door		mm	614
		inch	24,17
ELECTRIC HEATING			
Evaporation capacity		L/h	4,2
		US gallon/h	1,11
Hourly output		Kg/h	8,4
		lb/h	18,52
Installed heating power		kW	2
Installed electrical power		kW	2,74
GAS HEATING			
POWER AND VENTILATION			
Drum motor power		kW	0,17
Fan motor power		kW	0,17
Nominal air flow rate		m ³ /h	Variable
		cfm	Variable
Ø Fume exhaust		mm	-
Ø Fume exhaust		inch	-
HEAT EMISSION			
Maximum total heat emission		kW	0,3
		Btu/h	1075
Max. front heat emission		kW	0,2
		Btu/h	753
CONNECTIONS			
NET DIMENSIONS / D. WITH PACKING			
Net / gross width		mm	680 / 710
		inch	26,8 / 28
Net / gross depth		mm	750 / 832
		inch	29,5 / 32,8
Net height / gross height without heating		mm	1.400 / 1.520
		inch	55,1 / 59,8
Net / gross weight		Kg	174
		lb	384
OTHERS			
Sound level		dB	61



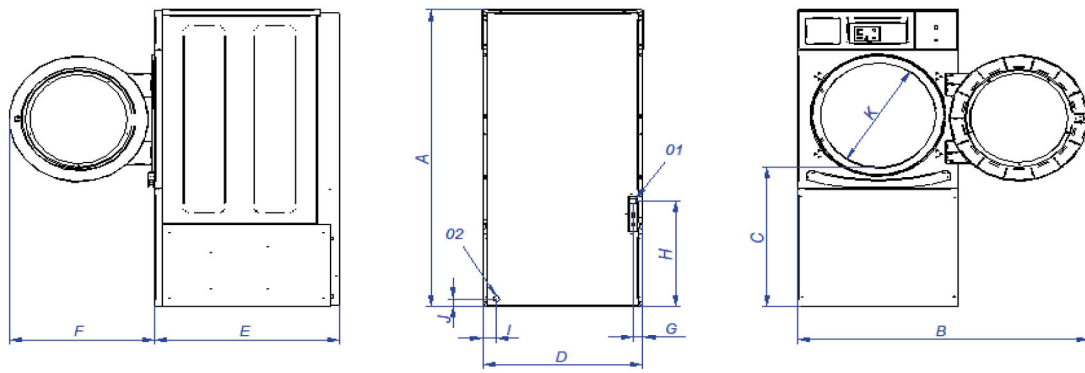

01. Electrical connection
 02. Condensed water evacuation
 3000mm hose (1) and 12mm
 diameter.
 (1) For greater distances,
 consult the installation manual.

		A	B	C	D	E	F	G	H	I	J	K
DP-8 T2 Hpi	mm	1.400	1.227	665	680	784	615	42	505	60	50	480
DP-10 T2 Hpi	mm	1.400	1.227	665	680	784	615	42	505	60	50	480

