



Primer

DS-80 P

STANDARD dryers

P CONTROL

Push buttons to control temperature and time.

OUTSTANDING FEATURES

Reversing drum action as standard.
Stainless steel drum as standard.
Frequency inverter as standard.

EFFICIENCY

DUAL AIRFLOW - Optimized system of mixed air flow.
Big fluff filter.

VERSATILITY

Make to order: customisation.
OPL > Coin laundry - Standard OPL model easily trasformable to coin laundry uses.

ERGONOMICS

Drawer as fluff filter, stainless steel mesh.
Biggest door diameters.
Opening sense of door adjustable on site (models without sliding door).

EASY MAINTENANCE

Hinged control panel: easy and ergonomic access.
Technical menu: statistics for technicians and maintenance with external console (with console option).
Easy to access to components

OTHERS

Grey Skinplate outer casing, stainless steel look.
EFFICIENT DRUM: the new drum with stamped holes.
COOL DOWN: anti-wrinkle at the end of the cycle.
Heating options: electric, gas and steam.
CE approved.

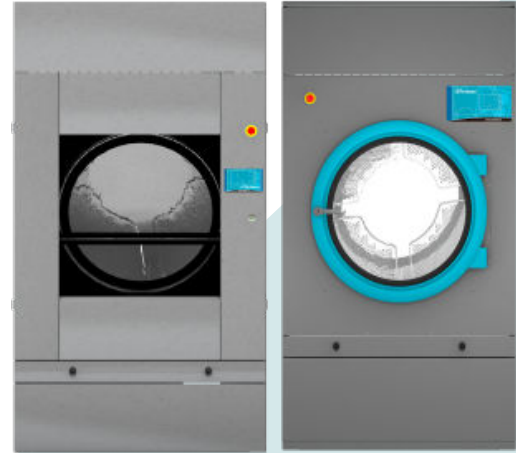

OPTIONS

- 440/480V 3~ 60 Hz DO-45-60-80
- Manual sliding door DS-45/60/80 (no double glass)
- Double doorglass DS-28/35/45/60/80
- Opposite door opening DS-45/60/80
- Back panel with air filter DS-45/60/80
- Fluff filter with grid 0/6 mm (standard is 0/3 mm)
- Fluff filter with grid 1/2 mm (standard is 0/3 mm)
- Stainless steel front and side panels DS-80
- Low pressure steam battery DS-45/60/80
- Maritime wooden packing DS-80
- NG gas option (Natural)
- 400 V III N 60 Hz DS-45/60/80 E/S
- 400 V III N 60 Hz DS-45/60/80 G
- 230 V III 50 Hz DS-45/60/80 G
- 230 V III 60 Hz DS-45/60/80 E/S
- 230 V III 60 Hz DS-45/60/80 G
- 400 V III 50 Hz DS-60/80
- 440/480V III 60 Hz DS-45/60/80
- 230 V III 50 Hz DS-45/60/80 E
- 230 V III 60 Hz DS-45/60/80 E

CAPACITY & DRUM		UNIT.	DS-80 P
Capacity 1/18		Kg	83,3
		lb	183,6
Capacity 1/20		Kg	75
		lb	165,3
Ø Drum		mm	1.225
		inch	48,23
Drum length		mm	1.252
		inch	49,29
Drum volume		l	1.500
		cu ft	52,95
Ø Door hole		mm	802
		inch	31,57
Door center height		mm	1.275
		inch	50,20
Height from floor to bottom of door		mm	813
		inch	31,99
ELECTRIC HEATING			
Evaporation capacity		L/h	64
		US gallon/h	16,9
Hourly output		Kg/h	128,6
		lb/h	283,5
Installed heating power		kW	72
Installed electrical power		kW	74,65
Drum motor power		kW	1,50
GAS HEATING			
Evaporation capacity (gas model)		L/h	86,5
		US gallon/h	22,851
Hourly output (gas model)		Kg/h	173,1
		lb/h	381,6
Installed gas heating power		kcal/h	103181
		Btu/h	409456,9
Installed gas heating power		kW	120
Installed electrical power		kW	2,65
Instant propane gas consumption (G31)		Kg/h	10,28
		lb/h	22,66
Instant natural gas consumption (G20)		m ³ /h	12,71
		cfm	7,48
Ø Gas inlet		BSPP ISO 228-1	3/4"
STEAM HEATING			
Installed steam heating power		kW	128
		Btu/h	436754
Installed electrical power		kW	2,65
Steam consumption (8 barG) - Standard		kg/h	171
Steam consumption (116 psiG)		lb/h	206
Steam pressure		barG	7 - 12
		psiG	101,5 - 178
Standard steam inlet - outlet		BSPT- ISO7.1	1"
Standard steam inlet - outlet		NPT ANSI B1.20.1 Tapered	1"
Steam consumption (5 barG) - Low Pressure		kg/h	147
Steam consumption (72,5 psiG) - Low Pressure		lb/h	177,1
Steam pressure (low pressure)		barG	4 - 7
		psiG	58 - 101,5
Low pressure steam inlet - outlet		BSPT- ISO7.1	1" 1/2
THERMAL OIL HEATING			
Installed heating power		kW	128
Installed electrical power		kW	2,65
Fluid consumption (T max 175°C)		m ³ /h	10



Thermal oil connection	BSP	1" 1/2	
VENTILATION			
Fan motor power	kW	1,1	
Nominal air flow rate	m ³ /h	3.000	
	cfm	1765,73	
Ø Fume exhaust	mm	300	
Ø Fume exhaust	inch	11,81	
HEAT EMISSION			
Maximum total heat emission	kW	6,48	
	Btu/h	22123,6	
Max. front heat emission	kW	2,88	
	Btu/h	9832,7	
CONNECTIONS			
Tension 230V - I + N + T	Nº x mm ² / A	-	-
Tension 230V - III + T	Nº x mm ² / A	-	4 x 2,5 / 25A
Tension 400V - III + N + T	Nº x mm ² / A	5 x 50 / 125A	5 x 2,5 / 25A
NET DIMENSIONS / D. WITH PACKING			
Net / gross width	mm	1.270 / 1.330	
	inch	50 / 52,36	
Net / gross depth	mm	1.598 / 1.705	
	inch	62,91 / 67,13	
Net height / gross height without heating	mm	2.380 /*2.200	
	inch	93,70 / *86,61	
Net / gross weight	Kg	657 / 715	
	lb	1.448,44 / 1.576,31	
OTHERS			
Sound level	dB	67	

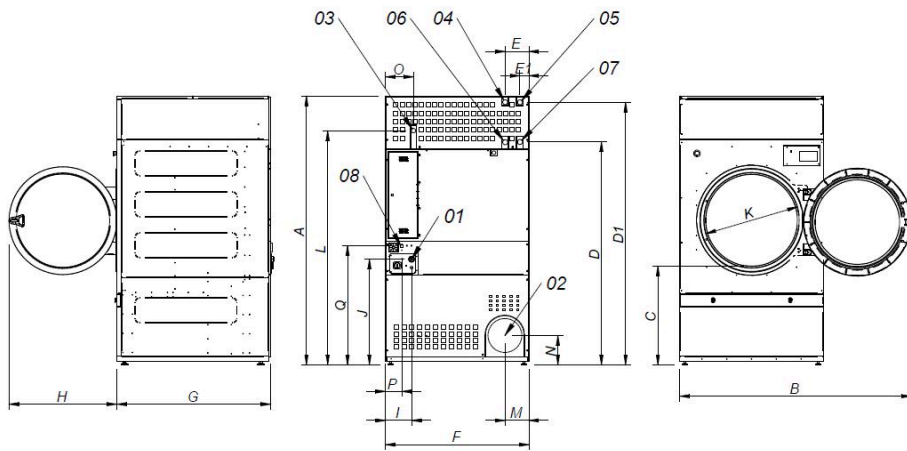

- 01 ELECTRIC CONNECTION
- 02 FUMES OUTLET Ø300
- 03 GAS CONNECTION 3/4"
- 04 STEAM CONNECTION (DS-45) 1"
- 05 STEAM CONNECTION (DS-60/80) 1"
- 06 CONDENSATION OUTLET (DS-45) 1"
- 07 CONDENSATION OUTLET (DS-60/80) 1"
- 08 ETHERNET CONNECTION (only available T2 CONTROL models)

* Measurement with legs mounted (30mm)

	A	B	C	D	D1	E	E1	F	G	H	I	J	K	L	M	N	O	P	Q
DS-45	2380*	2045	874	1981	2311	211	80	1270	1106	956	248	935	802	2088	214	240	244	160	1053
DS-60	2380*	2045	874	1981	2311	211	80	1270	1366	956	248	935	802	2088	214	240	244	160	1053
DS-80	2380*	2045	874	1981	2311	211	80	1270	1598	956	248	935	802	2088	214	240	244	160	1053

