



Primer

DDL-18 P TURBO BASIC Stack dryers

P CONTROL

Push buttons to control temperature and time.

OUTSTANDING FEATURES

Reversing drum action as standard.
Stainless steel drum as standard.
Frequency inverter as standard.

VERSATILITY

Make to order - customisation.
OPL > Coin - Standard OPL model easily trasformable to coin laundry uses.

ERGONOMICS

Drawer as fluff filter, stainless steel mesh.
Biggest door diameters.

EASY MAINTENANCE

Hinged control panel: easy and ergonomic access.
Technical menu: statistics for technicians and maintenance with external console.

OTHERS

White painted panels.
COOL DOWN: anti-wrinkle at the end of the cycle.
Filter drawer with wide surface and improved airflow.
Heating options: electric and gas, except DDL-22 T2 gas only.
CE approved

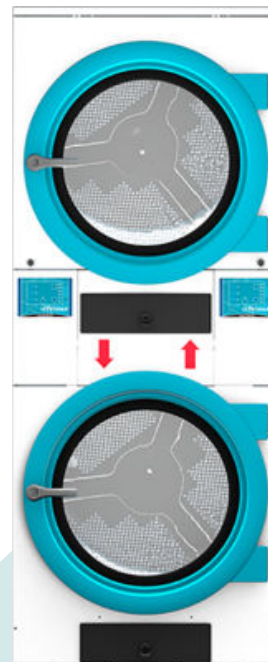

OPTIONS

- Screen in P programmer (2 units)
- Fluff filter with grid 0,3 mm (standard in is 0,6 mm)
- NG gas option (Natural) for DDL
- Maritime wooden packing DDL-18
- 400V III 50Hz 11/14/18kg
- 400V III 60Hz 11/14/18/22kg
- 230V III 60Hz 11/14/18kg G
- 230V III 60Hz 11/14/18kg E
- 440V/480V III 60Hz 11/14/18/22kg (maritime)
- Several payment systems for self-service

CAPACITY & DRUM		UNIT.	DDL-18 P TURBO	
Capacity 1/18		Kg	18,3	
		lb	40,4	
Capacity 1/20		Kg	16,5	
		lb	36,3	
Ø Drum		mm	750	
		inch	29,53	
Drum length		mm	746	
		inch	29,37	
Drum volume		l	330	
		cu ft	11,64	
Ø Door hole		mm	574	
		inch	22,60	
Door center height		mm	547 / 1522	
		inch	21,54 / 59,92	
Height from floor to bottom of door		mm	260 / 1.235	
		inch	10,24 / 48,62	
ELECTRIC HEATING				
Evaporation capacity		L/h	-	
		US gallon/h	-	
Hourly output		Kg/h	-	
		lb/h	-	
Installed heating power		kW	-	
Installed electrical power		kW	-	
Drum motor power		kW	0,37 x2	
GAS HEATING				
Evaporation capacity (gas model)		L/h	35,3	
		US gallon/h	9,325	
Hourly output (gas model)		Kg/h	70,7	
		lb/h	155,9	
Installed gas heating power		kcal/h	20650 x2	
		Btu/h	81891,4 x2	
Installed gas heating power		kW	24 x2	
Installed electrical power		kW	1,94	
Instant propane gas consumption (G31)		Kg/h	2,06 x2	
		lb/h	4,54 x2	
Instant natural gas consumption (G20)		m ³ /h	2,54 x2	
		cfm	1,49 x2	
Ø Gas inlet		BSPP ISO 228-1	1/2"	
VENTILATION				
Fan motor power		kW	0,55 x2	
Nominal air flow rate		m ³ /h	750 x2	
		cfm	441,43 x2	
Ø Fume exhaust		mm	200 x2	
Ø Fume exhaust		inch	7,78 x2	
HEAT EMISSION				
Maximum total heat emission		kW	2,5	
		Btu/h	8353,4	
Max. front heat emission		kW	1,8	
		Btu/h	6145,5	
CONNECTIONS			E	G / S
Tension 230V - I + N + T		Nº x mm ² / A	-	3 x 2,5 / 20A
Tension 230V - III + T		Nº x mm ² / A	-	3 x 2,5 / 20A
Tension 400V - III + N + T		Nº x mm ² / A	-	3 x 2,5 / 20A
NET DIMENSIONS / D. WITH PACKING				
Net / gross width		mm	785 / 865	
		inch	30,91 / 34,06	



Net / gross depth	mm	1.443 / 1.457
	inch	53,81 / 57,36
Net height / gross height without heating	mm	1.980 / 2.126
	inch	77,95 / 83,70
Net / gross weight	Kg	320 / 349
	lb	705,48 / 769,41
OTHERS		
Sound level	dB	64

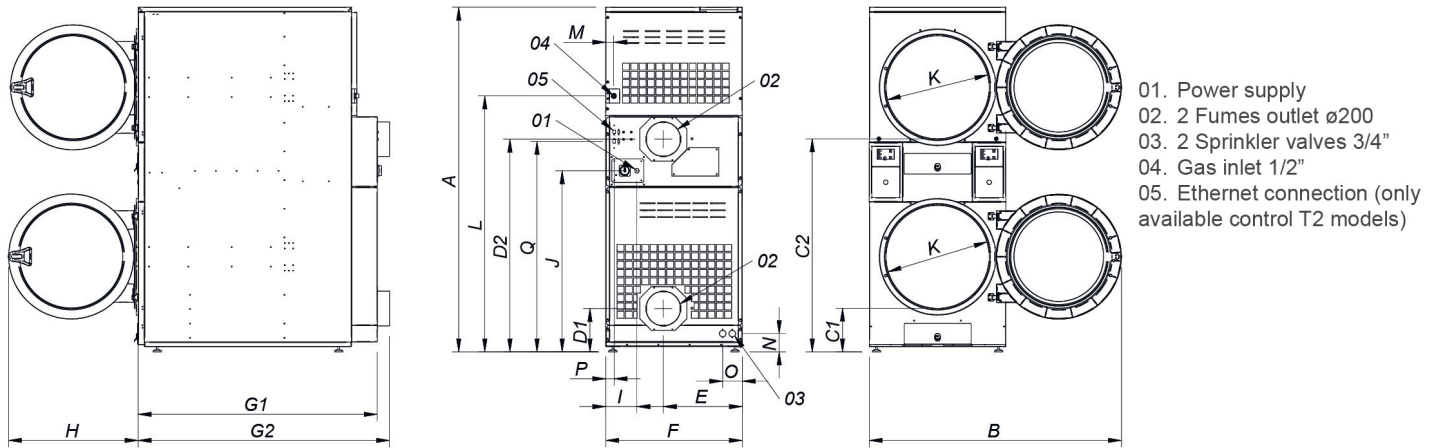

* Measurement with legs mounted (30mm)

	A	B	C1	C2	D1	D2	E	F	G1	G2	H	I	J	K	L	M	N	O	P	Q
DDO-18 TURBO	1980*	1447	259	1234	250	1223	454	785	1374	1443	735	180	1040	575	1472	45	103	100	49	1210

