



# Primer

## DDS-22 XP

## XP stack dryers STANDARD

### OUTSTANDING FEATURES

Reversing drum action as standard.  
Stainless steel drum as standard.  
Frequency inverter as standard.

### EFFICIENCY

DOUBLE FLOW - mixed axial-radial airflow.  
Big fluff filter.

### VERSATILITY

Make to order - Customisation  
OPL > Self-service - Standard OPL model easily trasformable to coin laundry uses.

### ERGONOMICS

Drawer as fluff filter, stainless steel mesh.  
Biggest door diameters.

### EASY MAINTENANCE

Hinged control panel: easy and ergonomic access.  
Technical menu: statistics for technicians and maintenance with external console (with console option).

### OTHERS

Grey skinplate outer casing, stainless steel look.  
EFFICIENT DRUM- new drum with stamped holes.  
COOL DOWN - anti-wrinkle at the end of the cycle.  
Heating options: electric or gas except DDS-22 XP only gas.  
CE approved

### P CONTROL

P control: push buttons to control temperature and time.

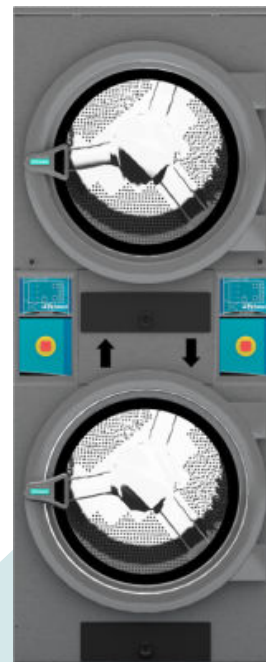

### OPTIONS

- 400V 3~60Hz 11/14/18/22 XP
- Double doorglass (order 1 unit per column)
- Screen in P programmer (2 units)
- Fluff filter with grid 0,3 mm (standard in STACK is 0,6 mm)
- Stainless steel AISI 304 outer casing for DDS-22
- Stainless steel AISI 304 front panel for DDS-22
- NG gas option (Natural) for DDS
- Maritime wooden packing DDS-22
- 400V 3~ 50 Hz 11/14/18/22 XP
- 400V 3N 60 Hz 11/14/18/22 XP
- 230V 3~ 60 Hz 11/14/18/22 G XP
- 230V 3~ 60 Hz 11/14/18 E XP
- 440/480V 3~ 60 Hz 11/14/18/22 XP (marine)
- Several payment systems for self-service

CAPACITY & DRUM		UNIT.	DDS-22 XP	
Capacity 1/18		Kg	24,3 x 2	
		lb	53,5 x 2	
Capacity 1/20		Kg	21,9 x 2	
		lb	48,3 x 2	
Ø Drum		mm	835	
		inch	32,9	
Drum length		mm	800	
		inch	31,5	
Drum volume		l	440	
		cu ft	15,54	
Ø Door hole		mm	575	
		inch	22,6	
Door center height		mm	574 / 1618	
		inch	22,60/63,70	
Height from floor to bottom of door		mm	214 / 1258	
		inch	8,46/49,53	
ELECTRIC HEATING				
Evaporation capacity		L/h *	-	
		US gallon/h *	-	
Hourly output		Kg/h **	-	
		lb/h **	-	
Installed heating power		kW	-	
Installed electrical power		kW	-	
GAS HEATING				
Evaporation capacity (gas model)		L/h	22 x 2	
		US gallon/h	5,81 x 2	
Hourly output (gas model)		Kg/h	44 x 2	
		lb/h	97 x 2	
Installed gas heating power		kcal/h ***	26139 x 2	
		Btu/h ***	103798 x 2	
		kW ***	30,4 x 2	
Installed electrical power		kW	1,94	
Consumption of propane gas average (G31)		Kg/h	2,08 x 2	
		lb/h	4,60 x 2	
Instant natural gas consumption (G20)		m <sup>3</sup> /h	3,22 x 2	
		cfm	1,89 x 2	
Ø Gas inlet		BSPP ISO 228-1	3/4"	
POWER AND VENTILATION				
Drum motor power		kW	0,37 x 2	
Fan motor power		kW	0,55 x 2	
Nominal air flow rate		m <sup>3</sup> /h	900 x 2	
		cfm	529,72 x 2	
Ø Fume exhaust		mm	250	
		inch	9,84	
HEAT EMISSION				
Maximum total heat emission 10-8% (9-7%)		kW	5	
		Btu/h	16934	
Max. front heat emission 7-5% (4-2%)		kW	1,9	
		Btu/h	6350	
CONNECTIONS			E	G / S
Tension 230V - I + N + T		Nº x mm <sup>2</sup> / A	-	3 x 2,5 / 20
Tension 230V - III + T		Nº x mm <sup>2</sup> / A	-	3 x 2,5 / 20 (5*)
Tension 400V - III + N + T		Nº x mm <sup>2</sup> / A		3 x 2,5 / 20 (6*)
NET DIMENSIONS / D. WITH PACKING				
Net / gross width		mm	870 / 950	
		inch	34,3 / 37,4	



Net / gross depth	mm	1312 / 1395
	inch	51,7 / 54,9
Net / gross height	mm	2118 / 2250
	inch	83,4 / 88,6
Net / gross weight	Kg	373,5 / 388,5
	lb	823 / 856
<b>OTHERS</b>		
Max. sound level (at 1m in front)	dB	69

\* Drying conditions: full load (1/20) of towels, drying temperature 90°C.

\*\* Kg dry linen per hour. Drying conditions: full load (1/20) of towels, drying temperature 90°C.

\*\*\* Calculation of thermal power from PCI.

(5\*) Connect 2 phases and earth.

(6\*) Connect phase, neutral and earth.

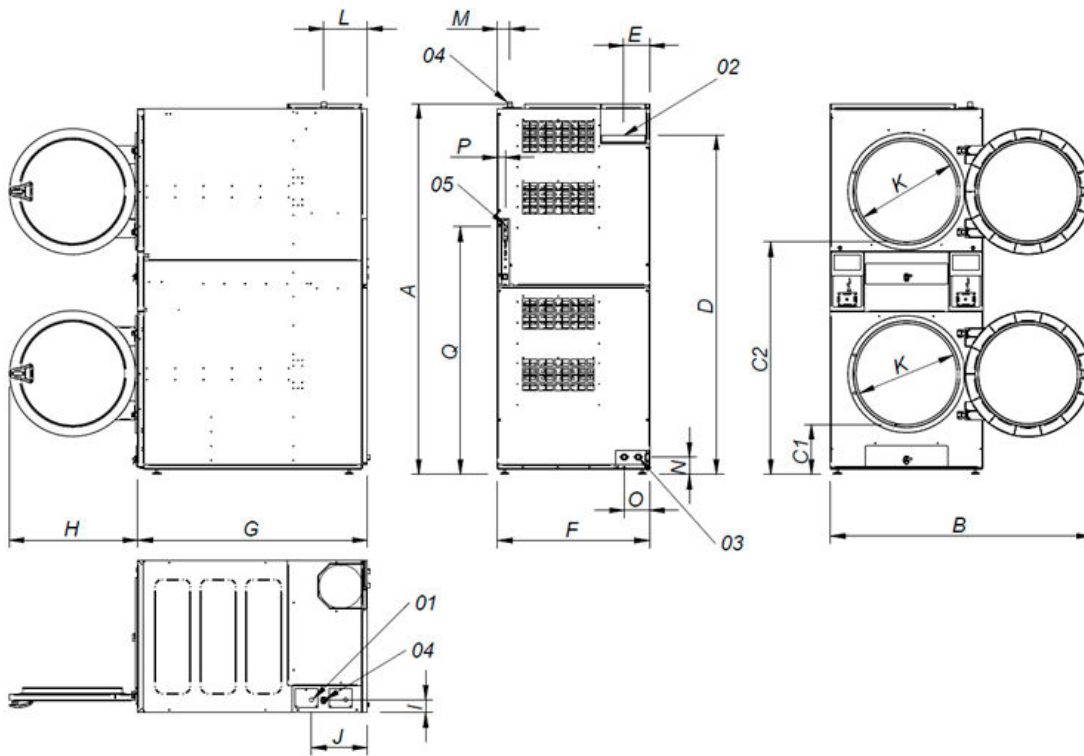

- 01. Power supply
- 02. Fumes output Ø250
- 03. 2 Sprinkler valves 3/4"
- 04. Gas inlet 3/4"
- 05. Ethernet connection (only T2 control)

		A	B	C1	C2	D	E	F	G	H	I	J	K	L	M	N	O	P	Q
DDS-22 XP	mm	2118	1490	286	1330	1940	149	870	1312	735	73	320	575	250	70	100	145	45	1416

