



### ELECTRONIC CONTROL

#### **PN-100/25, PN-120/25, PN-140/25, PN-200/25**

- Digital screen: precise control of temperature.
- Preset ironing speeds, not adjustable.

#### **PN-140/25, PN-200/25 EXCELLENCE**

- Simple and user friendly with an **automatic mode**: automatic management of ironing speed according to the selected temperature.
- Digital speed and temperature display.

### EFFICIENCY

Acoustic comfort: 65 dB max.

Minimum space requirement: space saving, suitable for small spaces.

Ideal for processing small quantity of flat linen in facilities like restaurants, guest rooms, hostels.

### ROBUSTNESS

**Nomex quality coating**: resistant to high temperatures (option, standard on EXCELLENCE).

Panels in grey Skinplate and stainless steel.

Wooden feeding board.

Industrial components, more durable.

### OUTSTANDING FEATURES

Large roll contact area with the linen.

Roll lifting control by pedal or automatic roll lifting control by foot cell detection.

Two available models:

- **Standard**: roll with cotton polyester coating.
- **Nomex**: roll with Nomex coating.

#### **Modelos EXCELLENCE:**

- Large roll contact area with the linen.
- Mode of operation identical to a flatwork ironer: no roll lifting, more ergonomic.
- Models equipped with Nomex belts, suction and variable speed inverter, more productivity.
- Adjustable speed and temperature.

### EASY MAINTENANCE

Easy installation : requires only an electrical connection.

Easy access on both sides for maintenance.

Quick and easy dismantling of bearings.

### OTHERS

Front feeding and return.

Roll Ø 250 mm.

Working widths: 1.000, 1.200, 1.400 and 2.000 mm.

Electric heating.

CE certification.

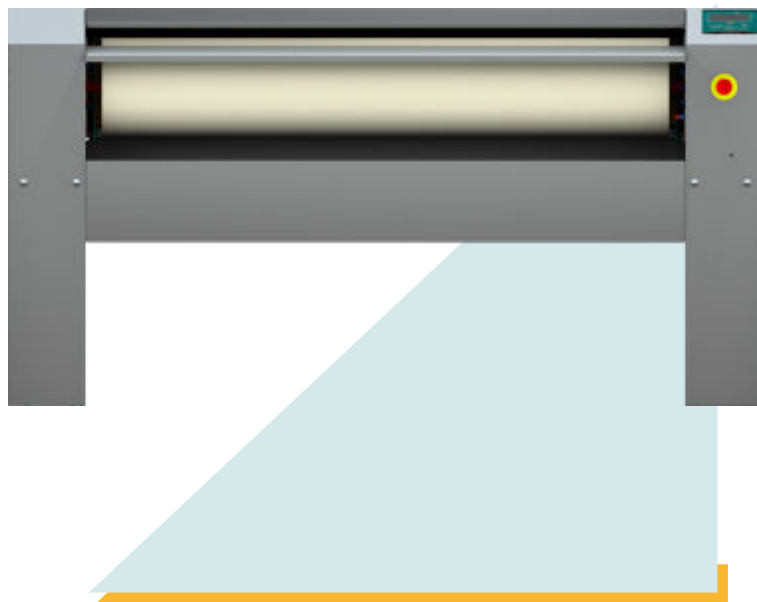

### OPTIONS

- Pedal control instead of photocell (except mod. EXCELLENCE)
- 230 V I N 50 Hz (except mod. 200 EXCELLENCE)
- 400 N T 60 Hz
- 440 V III 60 Hz No N (maritime)

GENERAL DETAILS		
Theoretical production: 20-25 humidity	Kg/h	30
	Lb/h	66,14
Roll Ø	mm	250
	inch	9,84
Working width	mm	1.400
	inch	55,12
Working speed	m/min	4.2
	ft/mn	13,77
Electronic control	-	YES
Chest motion	-	Automático
POWER		
Heating power	Kw	7
Roll motor power	Kw	0,18
Fan motor power	Kw	0
Total electric power	Kw	7,18
CONNEXIONS		
Tension 230 V I + N + T	nº x mm²/A	3 x 10 / 40A
	nº x AWG/A	3 x 7 / 40A
Tension 230 V III + T	nº x mm²/A	4 x 4 / 20A
	nº x AWG/A	4 x 11 / 20A
Tension 400 V III + N + T	nº x mm²/A	5 x 2,5 / 16A
	nº x AWG/A	5 x 13 / 16A
DIMENSIONS		
Net / gross width	mm	1.862 / 1.890
	inch	73,31 / 73,31
Net / gross depth	mm	484 / 540
	inch	19,06 / 21,26
Net / gross height	mm	985 / 1.130
	inch	38,78 / 44,49
Net / gross weight gross	Kg	134 / 154
	Lb	295,42 / 339,51
Net / gross volume gross	m³	0,89 / 1,15
	ft³	31,43 / 40,61
OTHERS		
No. Fume outlet	Nº	-
Ø Fume outlet	mm	-
	inch	-
Air flow	m³/h	-
	cfm	-
Noise Level	dB	55

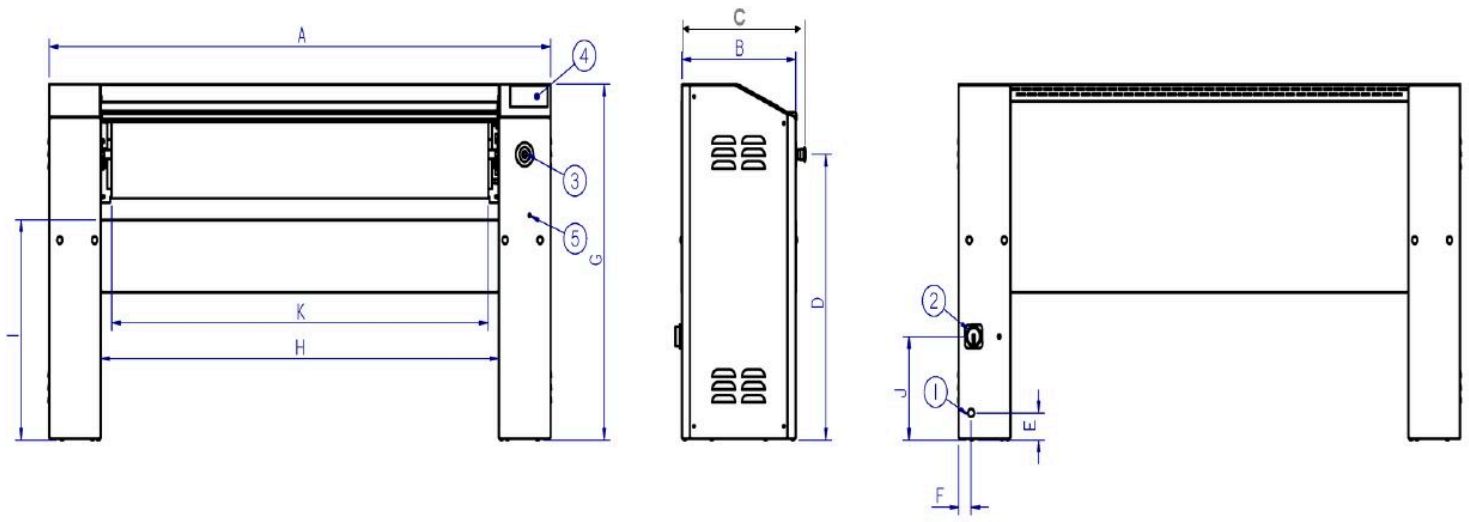

- 01. Electrical connection
- 02. Main switch
- 03. Emergency stop
- 04. Control panel
- 05. access to inverter maintenance

	A	B	C	D	E	F	G	H	I	J	K
PN-100/25	1.462	423	484	791	75	45	985	1.079	610	287	998
PN-120/25	1.662	423	484	791	75	45	985	1.279	610	287	1.198
PN-140/25	1.862	423	484	791	75	45	985	1.479	610	287	1.398
PN-200/25	2.462	423	484	791	75	45	985	2.079	610	287	1.998