



FEATURES

PRIMER automatic presses are easy to use thanks to their **pneumatic system**. They have a high pressure output, fully adjustable and with a variety of plates for different special applications.

- Universal chucks, steaming lower and upper chucks, optional polished upper chuck.
- Dimensions of the universal plate: 1170 x 380 x 220 mm.
- The wide upper plates facilitate pressing operations and the use of the steam iron.
- Lowering of the upper plate is operated by two push buttons. In this case, a finger guard is incorporated into the press to ensure the safety of the user.
- The presses are available with electric steam boiler, vacuum and compressor inside the press itself, or for connection to an external steam and air network.
- Lowering of the upper platen operated by two push buttons.
- Available with or without boiler.
- Available with or without compressor.
- All models equipped with Hoover.
- To be connected to the steam and air network.
- Air pressure: 6-7 bar
- Steam pressure: 4-5 bar
- Voltage: 230/400V III 50Hz

PRESS MODEL PRE-U

Universal press, upper and lower steaming plates, with optional polished upper plate for laundries.

- Universal plates, upper and lower steaming plates, optional polished upper plate.
- Plate dimensions : 1.170 x 360 x 220 mm.

PRESS MODEL PRE-CP

Press for collars and cuffs, lower and upper steaming plate. Polished upper plate, not steaming (optional).

- Collar and cuff plates, steaming lower plate.
- Polished upper platen.



OPTIONS

- Spotting vacuum arm
- group of iron + pedal
- polished upper buck
- spray gun for steam

GENERAL DETAILS	UNIT.	PRE-CP	
	With boiler	SIN CALDERA	
Board dimensions	mm	940 x 160	940 x 160
Boiler capacity	L	16	-
Boiler	-	OPT	OPC
Compressor	-	OPT	OPC
Group of iron	-	OPT	OPC
Steam gun	-	OPT	OPC
Polished upper buck	-	OPT	OPC
POWER			
Vacuum motor	HP	0,6	0,6
Pump motor	HP	0,75	-
Boiler heater (optional)	kW	2	2
Fan motor	kW	12	-
CONNECTIONS			
Ø Water inlet	BSP	3/8"	-
Ø Boiler exhaust (mod. with boiler)	BSP	1/2"	-
Ø Steam inlet	BSP	-	1/2"
Ø Condensate outlet	BSP	-	1/2"
Steam pressure	BAR	4-5	4-5
Steam Consumption	Kg/h	12-20	12-20
Ø Air inlet	BSP	-	3/8"
Air pressure	BSP	6-7	6-7
Air Consumption	NI/min	40	40
NET DIMENSIONS / PACKING DIMENSIONS			
Net width / Gross width	mm	1.370 / 1.440	1.370 / 1.440
Net depth / Gross depth	mm	1.080 / 1.110	1.080 / 1.110
Net height / Gross height	mm	1.250 / 1.410	1.250 / 1.410
Net weight / Gross weight	kg	292 / 342	237 / 287
Volume	m ³	1,84 / 2,25	1,84 / 2,25
OTHERS			
Tension	V/Hz	230/400V III 50-60	230/400V III 50-60
Sound level	dB	70	70



PRESS
WITH BOILER (self-contained)

Water inlet \varnothing 12

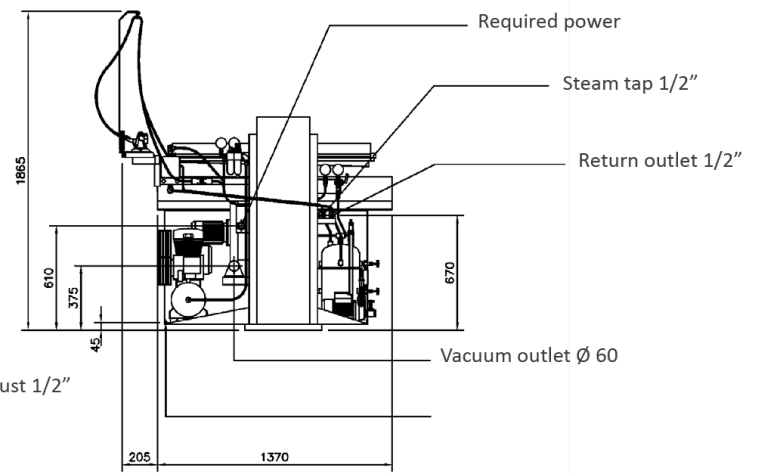
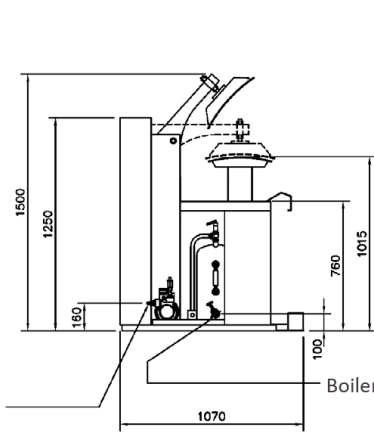

PRESS
WITHOUT BOILER

Connection to central vacuum supply \varnothing 60

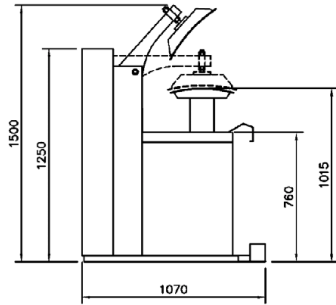

Air inlet 3/8"

